

# Baby Cot Template

Sized to fit a standard A6 card

[www.shannonkissane.com](http://www.shannonkissane.com)

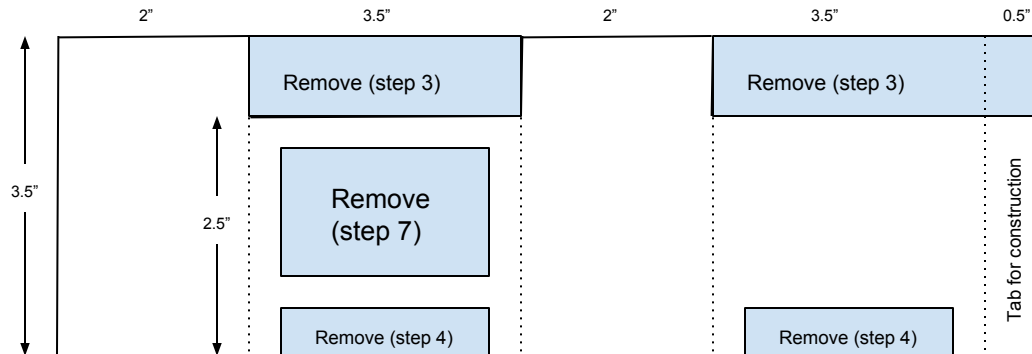

1. Cut Paper to 3.5" x 11.5"
2. On the 11.5" side, score at 2", 5.5", 7.5" & 11"
3. On the 3.5" side, at 1" from the top, cut between the two longer scored sections.
4. For the bottom sections, either use a fancy punch (?) or use a bit of guess work to remove. These are the feet / bottom of cot. I tend to use trimmer to do the longer cuts and then just snip up from the bottom.
5. Fold / Burnish the score lines
6. Cut along the score lines to remove the sections labelled step 3.
7. To remove this section, use either your trimmer or a knife blade. Whatever is easiest. I only do this on one side of the cot as the other is against the back of the card anyway.
8. I used a scallop punch to punch the top of the ends (taller parts) for decoration. You could use whatever you like
9. Cut some strips to make some cot bars to stick over the void you removed in step 7. Make sure you stick these on what will be the inside of your cot.
10. Do any stamping / decorating that you want before sticking it together using the tab
11. To place in the card, I use fast fuse on the back of the cot and press into card, as close to the card base score line as possible without being on the score line.
12. Then add some fast fuse to the end of the cot (holding the cot flat) and then just close the card. This will adhere it nicely to the front of the card base. Now it should open / close with the card